

WAVE ENERGY

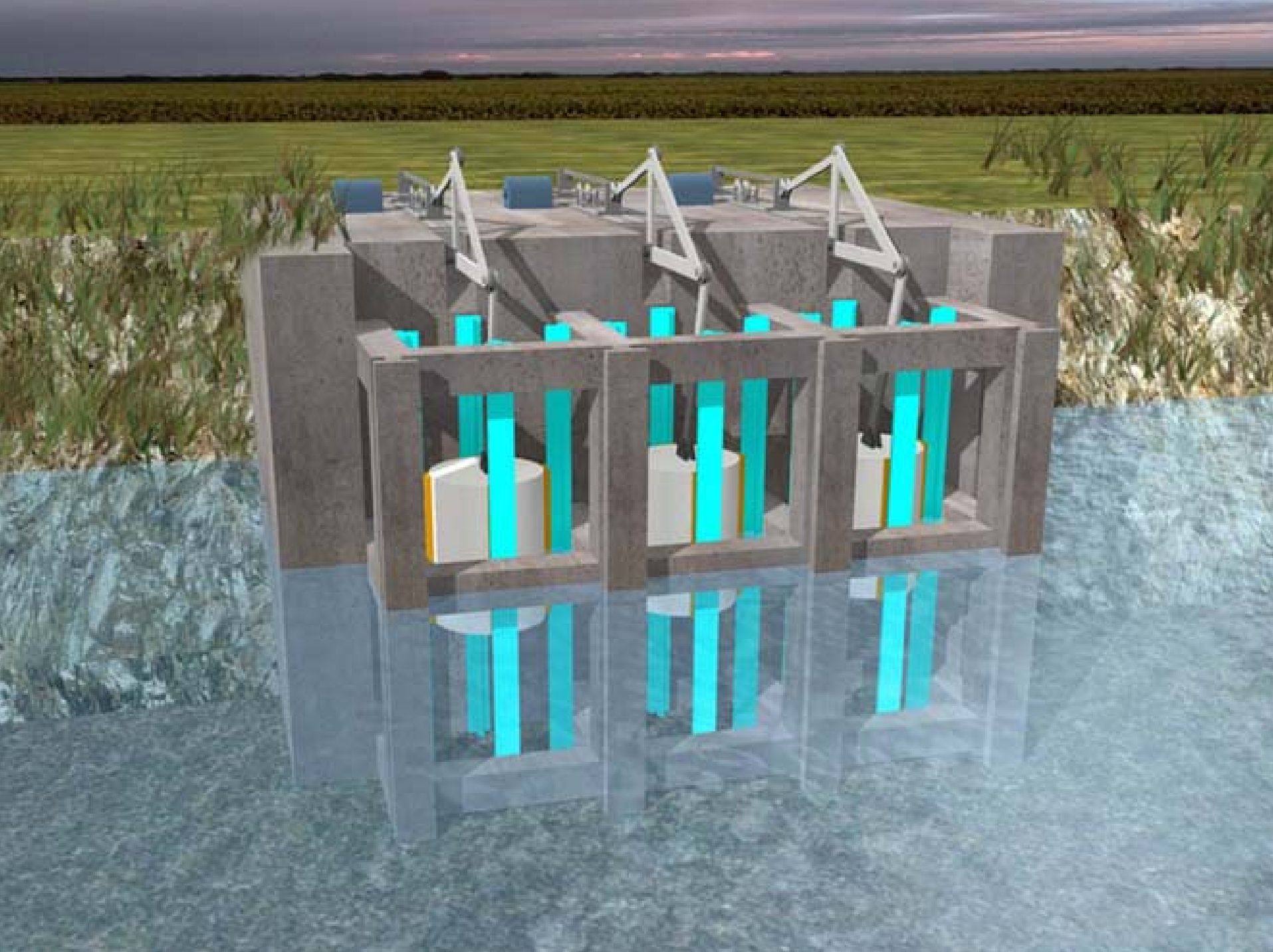

ELECTRICAL POWER CONVERTER

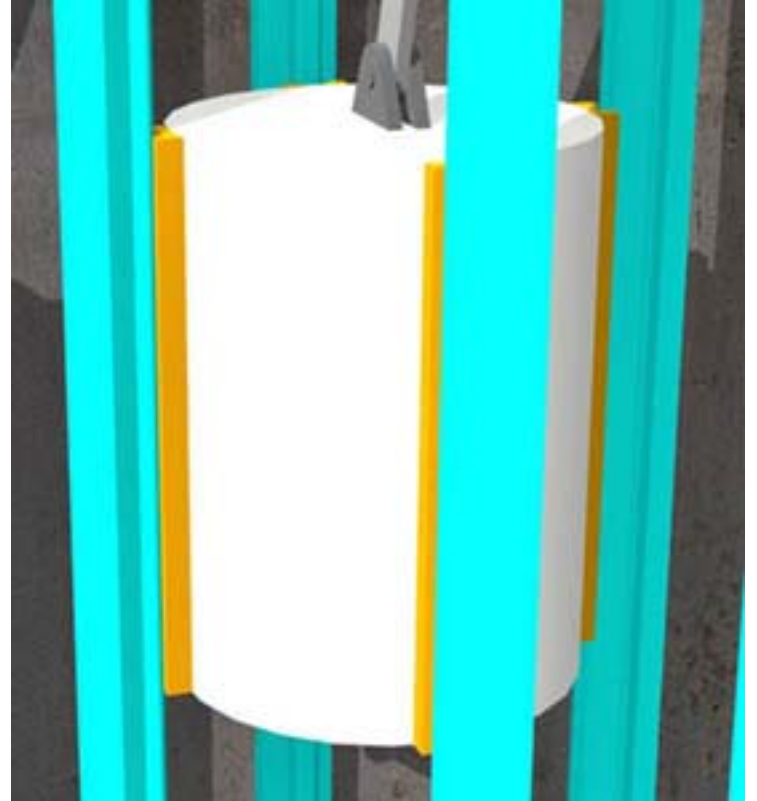

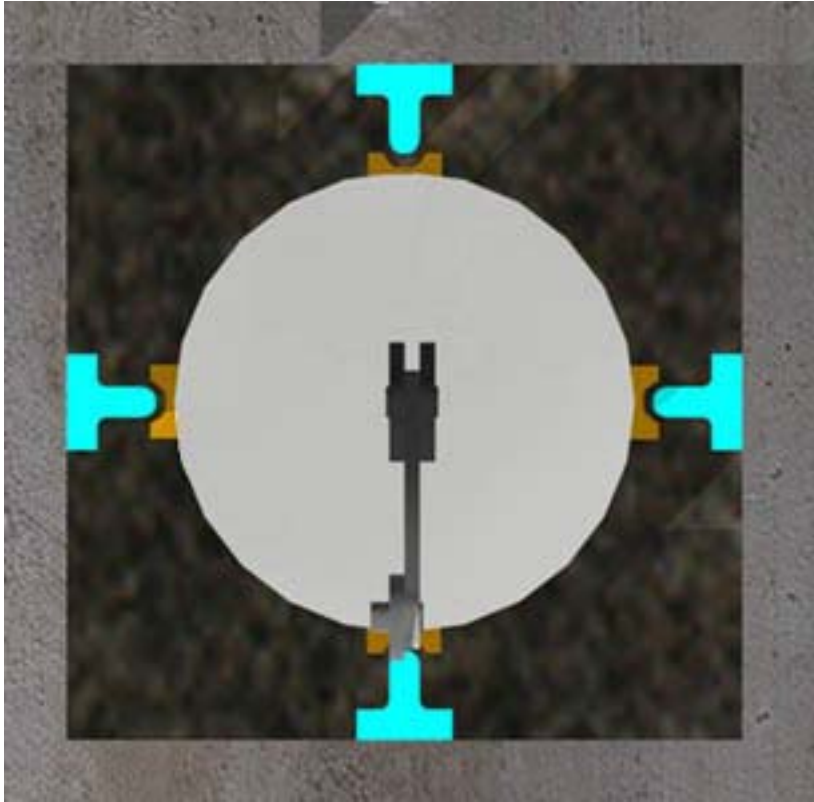

- A: The float moving vertically inside the recess
- B: The mechanism converting the vertical (up-down) movements of the float to horizontal
- C: The mechanism converting the movements to rotational
- D: Detail of the mechanism: the chains (c1 & c2), the gears (g1 & g2)
(the chains can be metal or synthetic fiber material)

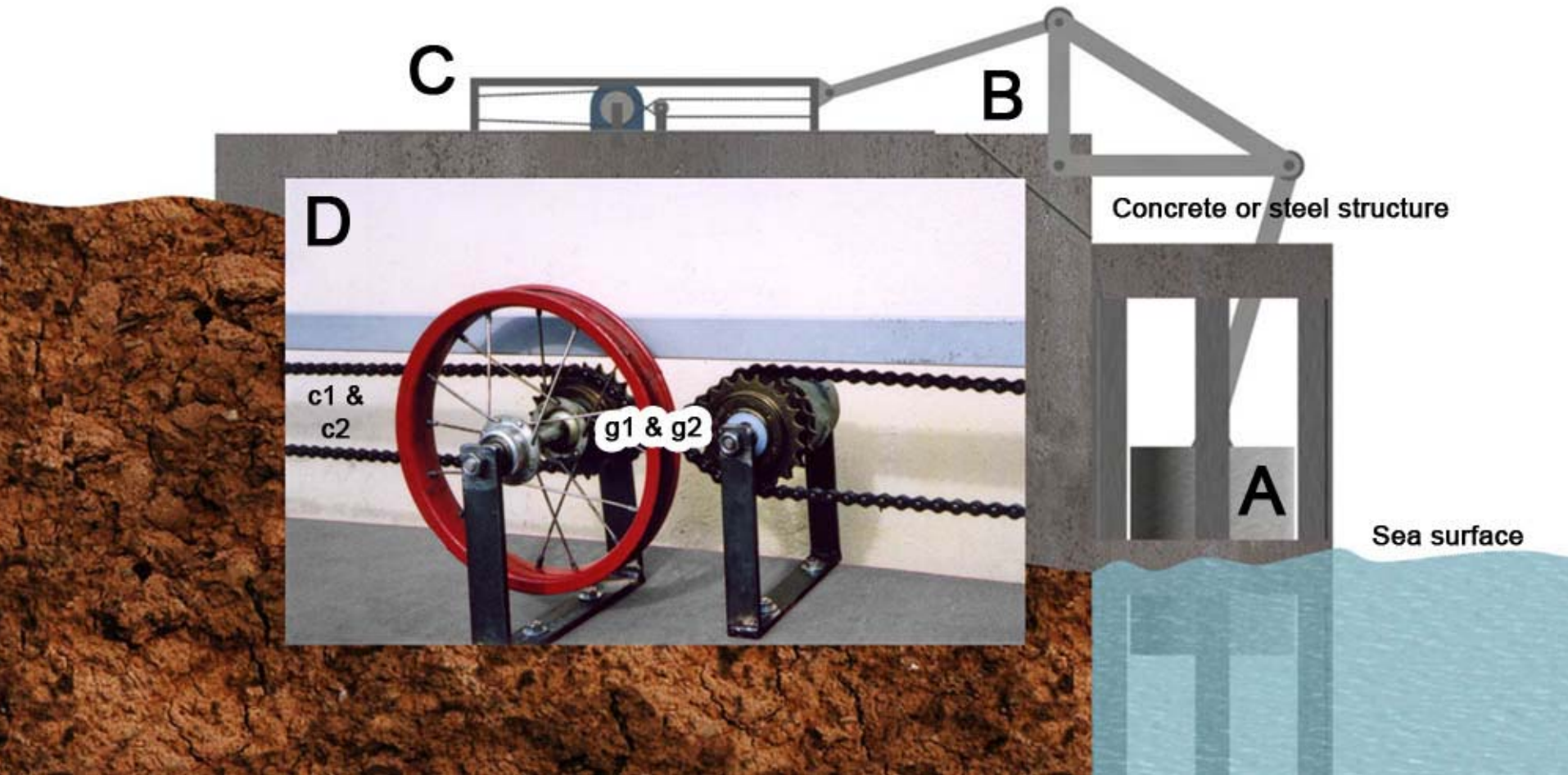

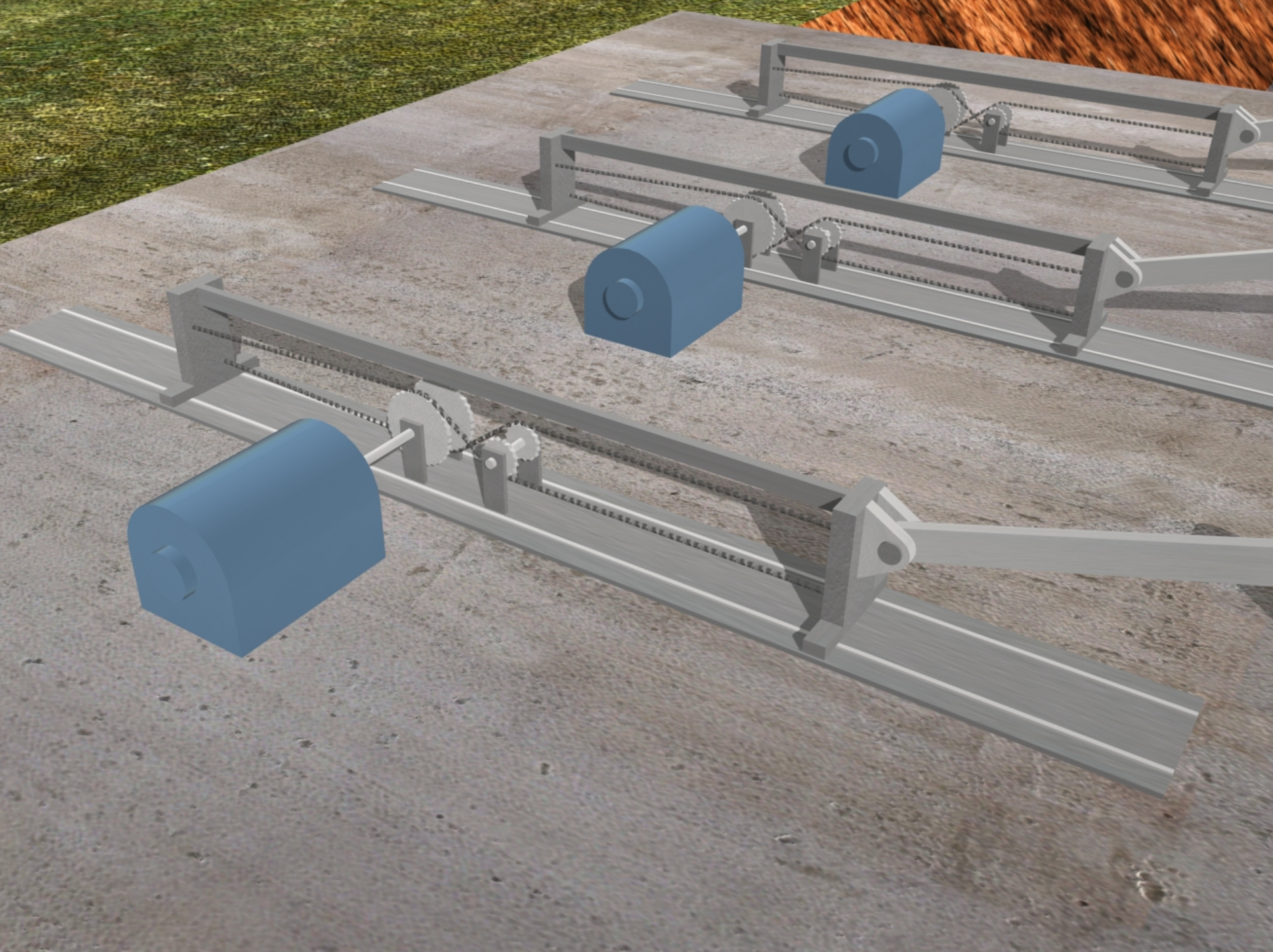



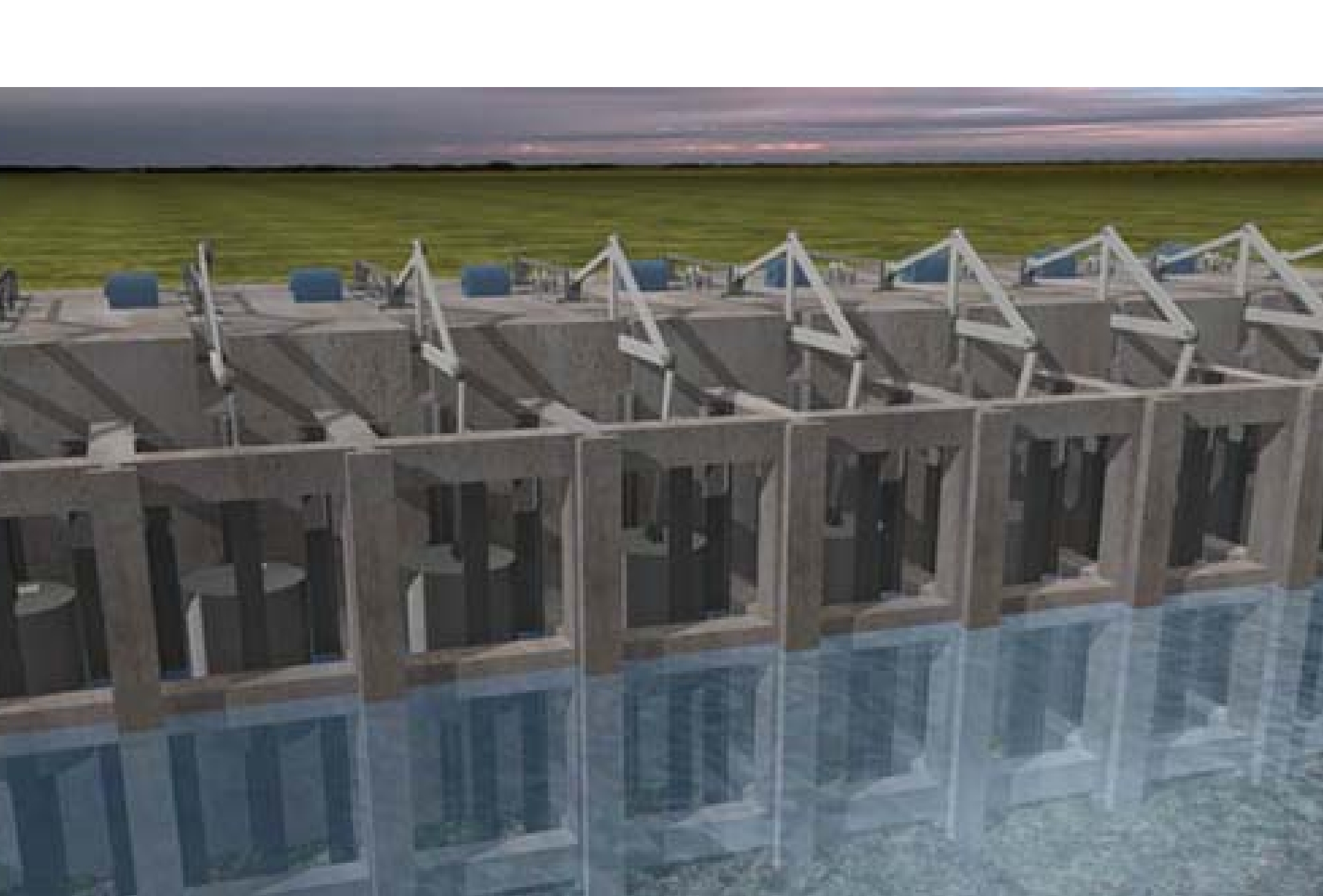



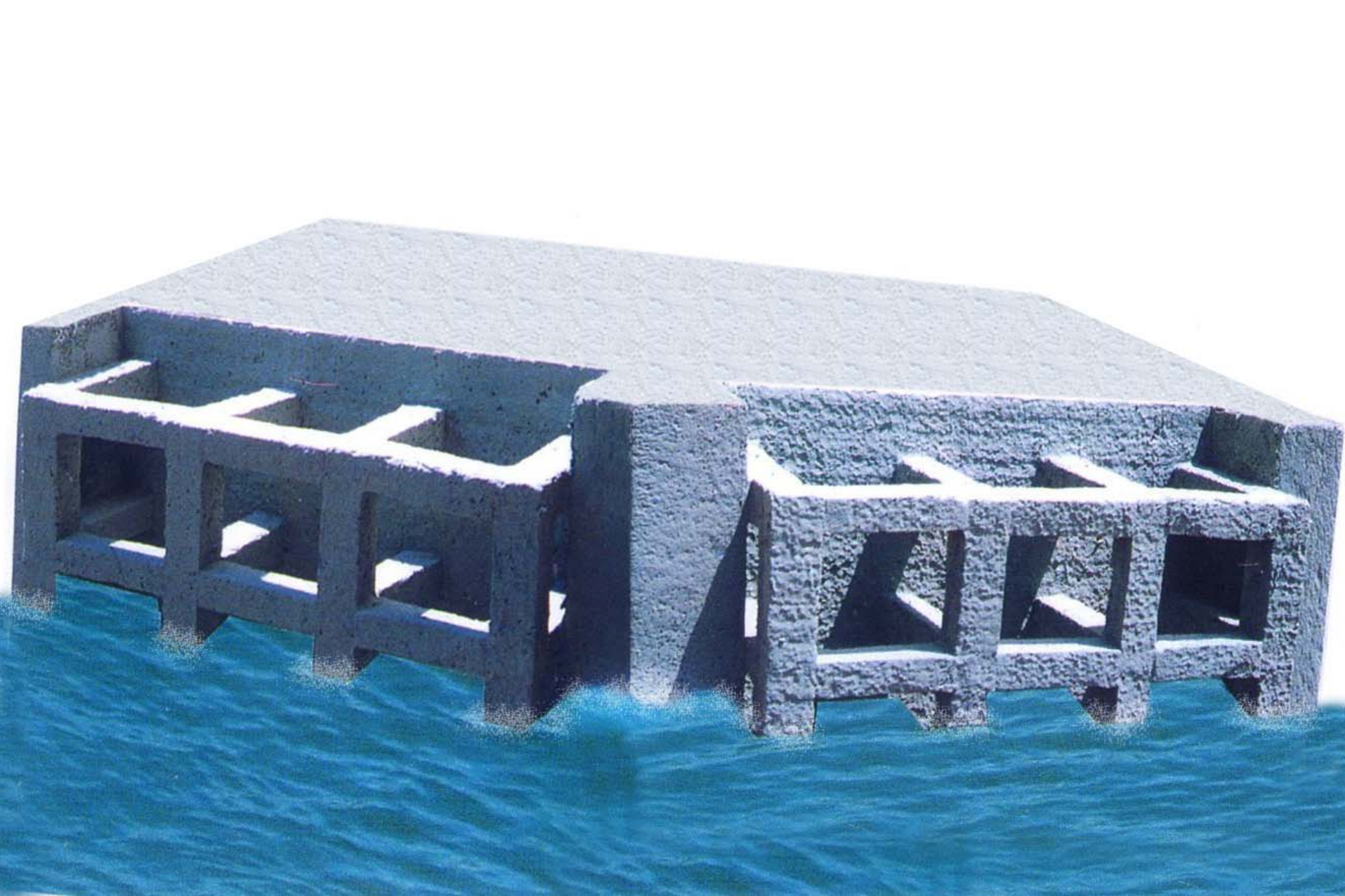

WAVE ENERGY



ELECTRICAL POWER CONVERTER